

ALISE 2006 ANNUAL CONFERENCE

**JANUARY 16-19, 2006
SAN ANTONIO, TEXAS**

From Research to Practice: The Scholarship

ALISE 2006 Annual Conference



January 16-19, 2006, San Antonio, Texas

of Teaching and Learning in LIS Education

CONFERENCE PROGRAM

2006 ALISE Annual Conference—San Antonio, TX

Message from ALISE President Ken Haycock

Welcome to the 2006 annual conference!

This year we celebrate the themes that connect us regardless of our disciplinary base or area of specialization. *From Research to Practice: The Scholarship of Teaching and Learning* opens new conversations around inquiry and constructivist theory. We have opportunities to explore the relationship between our scholarship and the content of our teaching and research into our teaching effectiveness and our pedagogy and student learning.

We have a robust conference with exceptional juried papers, reviews of research in progress and completed, networking events for similar interests and positions and San Antonio hospitality. The Association is strong and the conference reflects the growing confidence in ALISE to provide voice, vision and visibility for Library and Information Science educators. Intense interest in what we do and how we do it signifies the importance and impact of our work.

I look forward to meeting with you and learning from you.

Join with your colleagues in celebrating our research and investigating new means of enhancing student learning. *From Research to Practice: The Scholarship of Teaching and Learning* provides a framework for your research, teaching and service interests.

One Dozen Reasons to Attend ALISE 2006

1. **ALISE mission.** Help promote excellence in research, teaching, and service for library and information science education.
2. **Conference theme.** *From Research to Practice: The Scholarship of Teaching and Learning in LIS Education.*
3. **Plenary speaker.** Hear Randy Bass, Senior Scholar, Carnegie Institute for the Advancement of Teaching, on *The Difference that Inquiry Makes: Fostering a Scholarship of Teaching and a Culture of Learning.*
4. **Juried papers and panels.** Learn from the best of a highly competitive group of submissions.
5. **Works in Progress and Doctoral Student Research poster sessions.** Exchange research ideas with colleagues.
6. **Birds of a Feather.** Visit with people who share your teaching interests.
7. **Awards.** Celebrate colleagues' achievements.
8. **Vita and Portfolio review.** Polish your professional presentation or mentor new colleagues.
9. **Interviews.** Find your dream job or candidate.
10. **Colleagues.** Renew old friendships and develop new ones.
11. **Silent Auction.** Indulge yourself for a good cause.
12. **San Antonio.** Bask in sunshine in January.

Message from the Conference Program Planning Committee

¡Bienvenidos! The members of ALISE's Conference Program Planning Committee welcome you to the 2006 Conference, *From Research to Practice: The Scholarship of Teaching and Learning in LIS Education.* We had three goals in planning the program.

First, we wanted to present formal programs of the highest quality. The success of the ALISE Conference depends on the participation of members and the robust number and quality of submissions for juried papers and program presentations have allowed the committee to craft a very exciting and appealing program focusing on the links between research and teaching, academe and practice. We hope sessions will engage conference attendees with their intellectual content and interactions.

Second, our aim was to allow ALISE members to make intellectual and social connections with new colleagues as well as maintain those they already enjoy. To this end, we have incorporated several formal activities that provide opportunities for informal discussion and networking. The Vita and Portfolio Review, Works in Progress and Doctoral Research poster sessions, Birds of a Feather roundtable discussions, and SIG meeting times are all designed to foster the exchange of ideas and to promote professional relationships.

Finally, we wanted attendees to have fun! There are activities each night that invite fellowship and celebration, beginning with the opening night reception and concluding with the conference wrap-up. We hope you enjoy your time here in festive San Antonio and we trust you will leave here motivated and reinvigorated. ¡Olé!

General Information

Registration/ Materials

Registration will be open throughout the meeting. See the *Conference at a Glance* on Page 2 for times and locations. Conference materials will be distributed at the registration desk. **NOTE: attendees must wear name badges for entrance to receptions!**

Exhibits

Exhibits are located in the Pre-function Area.

Times: Tuesday 8:00 a.m. to 5:00 p.m.

Wednesday 8:00 a.m. to 5:00 p.m.

Thursday 8:00 a.m. to 12:00 noon

Cancellation Policy

Conference cancellations must be submitted in writing. Cancellations received prior to December 23, 2005 are subject to a \$25 cancellation fee. No refunds will be given for cancellations received after December 23, 2005.

Resolutions (see page 14)

Message Center/Lost and Found

A message center and lost and found check point will both be located in the registration area.

Conference Evaluation

The information that you provide on your conference evaluation will be critical to our improvements for future meetings. Please be sure to complete an evaluation and leave it at the registration desk or mail it to the ALISE office: P.O. Box 4219, Oak Ridge, Tennessee 37831-4219.

Placement Service

Arrangements for interviews should be made directly between candidates and recruiters using the Placement Service message board in the registration area. Please check the board often. When you have made your appointments, check at the registration desk to verify your interview room.

Omni San Antonio Hotel

9821 Colonnade Boulevard, San Antonio, Texas 78230

Phone: (210) 691-8888, Fax: (210) 691-1128

Explore the Attractions of San Antonio

Now the eighth largest city in the United States, San Antonio has retained its sense of history and tradition, while carefully blending in cosmopolitan progress. The city has always been a crossroads and a meeting place where culture and heritage of Native Americans, Old Mexico, the Wild West, African-Americans and the Deep South mingle and merge.

- **Alamo:** On the east side of Alamo Plaza is the most famous spot in Texas where 189 defenders fell on March 6, 1836, after repeated attacks by Mexican General Santa Anna's army. Mission San Antonio de Valero (The Alamo) was established in 1718 as the city's first mission. The chapel, one of the most photographed facades in the nation, and the Long Barracks are all that remain of the original fort. Located in the heart of the city, inside beautifully landscaped grounds. www.thealamo.org
- **Market Square:** Browse through the 32 shops at "El Mercado," an area patterned after an authentic Mexican market. In addition, there are 80 specialty shops in Farmers Market Plaza. www.tavernini.com/mercado
- **River Walk:** Paseo Del Rio in the heart of downtown is the pride of the city. Cobblestone walkways lead visitors to the river-level restaurants and shops. The river bubbles to the surface on the grounds of the University of the Incarnate Word and flows to downtown, threading its way through the city one level below the hustle and bustle of city streets. www.thesanantonioriverwalk.com
- **San Antonio Museum of Art:** A castle-like building housing a collection ranging from ancient art to Mexican folk art. Original home of Lone Star Brewing Company. www.sa-museum.org
- **Guenther House:** Located on a bend of the San Antonio River at the foot of King William is one of the oldest historic districts in Texas. The restored house offers a museum featuring mill memorabilia. Of interest to collectors are the Dresden China anniversary plates made in Germany until WWII. www.guentherhouse.com
- **La Villita:** A unique arts and crafts community with shops, working artists, restaurants and a post office. The Old San Antonio Exhibit (located in Bolivar Hall) houses a collection of art objects, artifacts and symbols relevant to the history. www.lavillita.com
- **San Antonio Botanical Garden, Lucile Halsell Conservatory:** A 33-acre living museum. Highlights include the Old Fashioned Perennial Garden, Rose Garden, Sacred Garden, Garden for the Blind, Kuamoto En (an authentic Japanese Garden), and extensive native collections representing the Hill Country, East Texas and Southwest Texas. The Lucile Halsell Conservatory features plants from around the world www.sabot.org
- **San Antonio Missions National Historical Park:** The park contains the historically and architecturally significant structures of missions Concepción, San José, San Juan and Espada. www.nps.gov/saan
- **Spanish Governor's Palace:** A national historic landmark, labeled "the most beautiful building in San Antonio" by the National Geographic Society. Distinguishing features include period furnishings and a cobblestone patio with fountain and foliage. www.sanantonio.gov/sapar/spanishgovernorspalace.asp

Conference at a Glance

Date/Time	Event	Room	Date/Time	Event	Room
Monday, January 16, 2006			Wednesday, January 18, 2006		
8:00 a.m.-6:00 p.m.	Registration	Pre-function area	7:30 a.m.-8:30 a.m.	School Representatives' Breakfast	La Joya Ballroom
8:00 a.m.-8:00 p.m.	Placement Services	Pre-function area	8:00 a.m.-7:00 p.m.	Registration	Pre-function Area
8:30 a.m.-1:30 p.m.	Council of Deans/Directors	Grand Ballroom D/E	8:00 a.m.-8:00 p.m.	Placement Services	Pre-function Area
12:30 p.m.-4:30 p.m.	Online Pedagogy Workshop	Grand Ballroom F/G	8:00 a.m.-5:00 p.m.	Exhibits	Pre-function Area
1:00 p.m.-3:00 p.m.	Information Literacy Workshop	Grand Ballroom C	8:00 a.m.-8:45 a.m.	SIG Session 1	Grand Ballroom A-F
1:00 p.m.-4:00 p.m.	Vita and Portfolio Review	Grand Ballroom A/B	9:00 a.m.-10:30 a.m.	Session 4: Panels & Papers	
2:00 p.m.-5:00 p.m.	ALISE Board Meeting 2	Board Room	4.1 Relationship of Research...	Grand Ballroom B	
4:30 p.m.-5:30 p.m.	ALISE Committee Meetings	Colonnade Ballroom	4.2 Information Ethics Positioning	Grand Ballroom C	
6:00 p.m.-7:00 p.m.	Opening Reception/Works in Progress Poster Session	Grand Ballroom	4.3 Effective Strategies...	Grand Ballroom E	
7:00 p.m.-10:00 p.m.	Night on the Town	Meet buses in Lobby	4.4 Beyond the Textbook...	Grand Ballroom F	
Tuesday, January 17, 2006			11:00 a.m.-12:30 p.m.	Session 5: Panels & Papers	
7:30 a.m.-8:30 a.m.	First-timers' Breakfast	La Joya Ballroom	5.1 Preparing Future Professionals	Grand Ballroom B	
8:00 a.m.-7:00 p.m.	Registration	Pre-function Area	5.2 Serving Our Students...	Grand Ballroom C	
8:00 a.m.-8:00 p.m.	Placement Services	Pre-function Area	5.3 Information Literacy Assessment	Grand Ballroom E	
8:00 a.m.-5:00 p.m.	Exhibits	Pre-function Area	5.4 Research in Youth Services	Grand Ballroom F	
8:30 a.m.-10:00 a.m.	Opening Session	Grand Ballroom	12:45 p.m.-1:30 p.m.	SIG Session 2	Grand Ballroom A-F
10:30 a.m.-12:00 noon	Session 1: Panels & Papers		1:45 p.m.-3:15 p.m.	Session 6: Panels & Papers	
1.1 Preparing Lib. Media Spec.	Grand Ballroom B		6.1 Preparing Students...	Grand Ballroom B	
1.2 Discussion with Randall Bass	Grand Ballroom C		6.2 Information Seeking and...	Grand Ballroom C	
1.3 ALISE Awards Panel	Grand Ballroom E		6.3 Interdisciplinary Research...	Grand Ballroom E	
1.4 Supporting Education ...	Grand Ballroom F		6.4 Two IMLS Grants...	Grand Ballroom F	
12:00 noon-12:45 p.m.	Birds of a Feather	La Joya Ballroom	3:45 p.m.-5:30 p.m.	ALISE Business Meeting	Grand Ballroom
2:00 p.m.-3:30 p.m.	Session 2: Panels & Papers		6:30 p.m.-8:00 p.m.	Awards Reception	Grand Ballroom
2.1 Teaching from a Distance	Grand Ballroom B		Thursday, January 19, 2006		
2.2 Innovative Curriculum...	Grand Ballroom C		8:00 a.m.-12:00 noon	Registration	Pre-function Area
2.3 Current Historical Scholarship	Grand Ballroom E		8:00 a.m.-12:00 noon	Placement Services	Pre-function Area
2.4 Using Online Repositories	Grand Ballroom F		8:00 a.m.-12:00 noon	Exhibits	Pre-function Area
2.5 Biomedical Informatics	Grand Ballroom A		8:00 a.m.-9:00 a.m.	Accreditation Reporting w/ALA	Colonnade Ballroom
3:45 p.m.-5:15 p.m.	Session 3: Panels & Papers		8:00 a.m.-8:45 a.m.	SIG Session 3	Grand Ballroom A-F
3.1 Future Look of Our Profession	Grand Ballroom B		9:00 a.m.-10:00 a.m.	Developing Program Presentation	Colonnade Ballroom
3.2 Building Community in DE	Grand Ballroom C		9:00 a.m.-10:30 a.m.	Session 7: Panels & Papers	
3.3 Metadata Education Resources	Grand Ballroom E		7.1 Serving our Students...	Grand Ballroom B	
3.4 Combating Grade Inflation	Grand Ballroom F		7.2 Inquiry with an Edge	Grand Ballroom C	
5:30 p.m.-7:00 p.m.	Past President's Reception	Presidential Suite	7.3 Student Outcome Assessment	Grand Ballroom E	
5:45 p.m.-6:15 p.m.	Doctoral Poster Session Setup	Grand Ballroom	7.4 Effect of NCATE Requirements	Grand Ballroom F	
5:45 p.m.-6:15 p.m.	Doctoral Poster Judges Meeting	Pre-function Area	10:45 a.m.-12:15 p.m.	Session 8: Panels & Papers	
6:15 p.m.-8:15 p.m.	Doctoral Poster Judging	Grand Ballroom	8.1 Olio	Grand Ballroom B	
8:30 p.m.-10:00 p.m.	Doctoral Student Reception	Grand Ballroom	8.2 OCLC/ALISE Grant Papers	Grand Ballroom C	
New this year...the ALISE Silent Auction			8.3 Critical Consciousness	Grand Ballroom E	
Auction bidding in the La Joya Ballroom			8.4 Issues in Scholarly Communication	Grand Ballroom F	
Bidding opens Tuesday, January 17, 12:00 noon			12:45 p.m.-1:30 p.m.	Closing Session	Grand Ballroom
Bidding closes Wednesday, January 18, 12:00 noon			1:45 p.m.-2:30 p.m.	Assistant/Associate Deans SIG	Board Room
(see page 15 for auction listing)			2:30 p.m.-3:30 p.m.	JELIS Editorial Board Meeting	Sam Houston
			2:30 p.m.-3:30 p.m.	ALISE Board w/Chairs & Conveners	Colonnade C
			3:30 p.m.-6:30 p.m.	ALISE Board Meeting	Colonnade B

Monday, January 16, 2006

8:00 a.m.–6:00 p.m.	Registration	Pre-function Area
8:00 a.m.–8:00 p.m.	Placement Services	Pre-function Area
8:30 a.m.–1:30 p.m.	Council of Deans and Directors Workshop	Grand Ballroom D\E
12:30 p.m.–4:30 p.m.	Online Pedagogy Workshop	Grand Ballroom F\G
1:00 p.m.–3:00 p.m.	Information Literacy Course Workshop	Grand Ballroom C
1:00 p.m.–4:00 p. m.	Vita and Portfolio Review	Grand Ballroom A\B
2:00 p.m.–5:00 p.m.	ALISE Board of Directors Meeting 2	Board Room
4:30 p.m.–5:30 p.m.	ALISE Committee Meetings	Colonnade Ballroom
5:30 p.m.–6:00 p.m.	Works in Progress Poster Session Set-up	Grand Ballroom
6:00 p.m.–7:00 p.m.	Opening Reception with Works in Progress Poster Session	Grand Ballroom
7:00 p.m.–10:00 p.m.	Night on the Town	Buses to Riverwalk

8:30 a.m. Council of Deans and Directors Workshop

[Grand Ballroom D\E]

Organizer: Michele Cloonan, Simmons College

(morning break courtesy of Simmons/lunch courtesy of Texas)

12:30 p.m. Best Practices for Online Pedagogy Workshop

[Grand Ballroom F\G]

WISE (Web-based Information Science Education)

Consortium

Distance Education SIG

Moderators: Linda Smith, University of Illinois &
Bruce Kingma, Syracuse University

Building on the success of similar previous WISE-sponsored events, this workshop explores best practices, with respect to both online teaching in general and in relation to teaching specific content areas in library and information science. The keynote presentation focuses on how the design of a course website can reflect the passions and pedagogical philosophy of the instructor.

- **Keynote Presentation: "On Becoming a Web Site"**
Punya Mishra, College of Education, Michigan State University
- **Panel Discussion of Online Teaching and Learning**
J. Stephen Downie, University of Illinois at Urbana-Champaign
Scott Nicholson, Syracuse University
Sue Alman, University of Pittsburgh
- **Breakout Session of Subject-Specific Pedagogical Strategies**
- **Summing Up**

1:00 p.m. Partnering with Schools of Education to Implement Best Practices in Teaching and Learning: Developing a Pre-service Teachers' Information Literacy Skills Course [Grand Ballroom C]

Organizers: Anne Perrault & Dan Barron, University of South Carolina

The organizers provide an overview of a jointly developed information literacy skills course, including specifics of the partnership between the two schools, ways in which development of this course was informed by research, research plans to follow the students' engagement with information literacy skills as educators, and examples of inquiry-based activities from the course in which students are co-constructing their own knowledge. Participants are encouraged to share copies of course syllabus with other workshop participants.

1:00 p.m. Vita and Portfolio Review

[Grand Ballroom A\B]

Polish your professional presentation. Senior faculty will review and critique curriculum vitae and portfolios in one-on-one 30 minute review sessions. Advance registered participants will receive preference.

2:00 p.m. ALISE Board of Directors Meeting 2

[Board Room]

4:30 p.m. ALISE 2005 and 2006 Committee Meetings

[Colonnade Ballroom]

5:30 p.m. Works in Progress Poster Session Setup

[Grand Ballroom]

6:00 p.m. Opening Reception and Works in Progress Poster Session (cash bar)

[Grand Ballroom]

The Works in Progress session, with more than 50 posters from faculty, doctoral students, and academic librarians presents research in its formative stages and provides an opportunity for presenters and conference attendees to exchange ideas in an informal setting.

7:00 p.m.– 10:00 p.m. Night on the Town

[Buses start leaving for Riverwalk at 6:45 p.m.; buses return to conference hotel at 10:00 p.m..]

Tuesday, January 17, 2006

7:30 a.m.–8:30 a.m.	<i>First-timers' Breakfast</i>	La Joya Ballroom
8:00 a.m.–7:00 p.m.	<i>Registration</i>	Pre-function Area
8:00 a.m.–8:00 p.m.	<i>Placement Services</i>	Pre-function Area
8:00 a.m.–5:00 p.m.	<i>Exhibits</i>	Pre-function Area
8:30 a.m.–10:00 a.m.	<i>Opening Session</i>	Grand Ballroom
10:30 a.m.–12:00 noon	<i>Session 1: Concurrent Panels & Juried Papers</i>	Grand Ballroom (sections B, C, E, F)
12:00 noon–12:45 p.m.	<i>Birds of a Feather</i>	La Joya Ballroom
2:00 p.m.–3:30 p.m.	<i>Session 2: Concurrent Panels & Juried Papers</i>	Grand Ballroom (sections B, C, E, F, A)
3:45 p.m.–5:15 p.m.	<i>Session 3: Concurrent Panels & Juried Papers</i>	Grand Ballroom (sections B, C, E, F)
5:30 p.m.–7:00 p.m.	<i>Past Presidents' Reception</i>	Presidential Suite
5:45 p.m.–6:15 p.m.	<i>Doctoral Poster Session Setup</i>	Grand Ballroom
5:45 p.m.–6:15 p.m.	<i>Doctoral Poster Judges Meeting</i>	Pre-function Area
6:15 p.m.–8:15 p.m.	<i>Doctoral Poster Judging</i>	Grand Ballroom
8:30 p.m.–10:00 p.m.	<i>Doctoral Student Research Poster Session and Reception</i>	Grand Ballroom

7:30 a.m. First-timers' Breakfast [La Joya Ballroom]

Host: ALISE President-Elect **John Budd**, *University of Missouri – Columbia*

Learn about ALISE and how you can get involved.

8:30 a.m. Opening Session [Grand Ballroom]

President's Welcome: ALISE President **Ken Haycock**, *San Jose State University*

Keynote Address: *The Difference that Inquiry Makes: Fostering a Scholarship of Teaching and a Culture of Learning*
Randall Bass, *Georgetown University*

Dr. Bass is an Associate Professor of English and a member of the American Studies Committee at Georgetown University. He serves as Assistant Provost for Teaching and Learning Initiatives at Georgetown, where he is also Executive Director of Georgetown's Center for New Designs in Learning and Scholarship (CNDLS, pronounced "CANDLES"), a University-wide center supporting faculty work in new learning and research environments. Since 2000, Bass has been the Director and Principal Investigator of the Visible Knowledge Project (VKP), a five-year scholarship of teaching project exploring the impact of technology on learning in the humanities. In conjunction with the VKP, he also directs the American Studies Crossroads Project, an international project on technology and education in affiliation with the American Studies Association, with major funding in the past by the US Department of Education's Fund for the Improvement of Postsecondary Education and the Annenberg/CPB Project.

Bass has authored or edited numerous articles, books, and electronic projects, including *Engines of Inquiry: A Practical Guide for Using Technology to Teach American Studies, Intentional Media: The Crossroads Conversations on Technology and Learning in the American Culture and History Classroom* (special double issue of *Works and Days*), and the forthcoming *The Difference that Inquiry Makes: Innovation,*

Technology, and the Scholarship of Teaching and Learning. In 1998–99, he served as a Pew Scholar and Carnegie Fellow in conjunction with the Pew-funded Carnegie Teaching Academy, for the Carnegie Foundation for the Advancement of Teaching. In 1999, he won the EDUCAUSE Medal for outstanding achievement in information technology and undergraduate education. Since 2003 he has been a Senior Scholar at the Carnegie Foundation for the Advancement of Teaching.

10:00 a.m.– 10:30 a.m. Morning Break

10:30 a.m. Session 1: Concurrent Panels & Juried Papers

1.1 ♦ Juried Papers 1: Preparing Future School Library Media Specialists [Grand Ballroom B]

Moderator: **Kyung-Sun Kim**, *University of Wisconsin-Madison*

School Library Media Specialists for the 21st Century: Leaders Educated to Make a Difference (Project LEAD)

Eliza Dresang, *Florida State University*

Nancy Everhart, *Florida State University* (with assistance of **Harry Buerkle**, *Florida State University*)

Part of an IMLS grant to foster leadership and integrate the tenets of the National Board for Professional Teaching Standards, this research focuses on development and administration of needs assessment, analysis of data collected, and proposed design for the certificate courses, the specialist degree, and other supporting educational experiences for school library media specialists.

Teacher and Librarian Collaboration: From Research to Practice

Patricia Montiel Overall, *University of Arizona*

Using an intensive research approach, this study tests the researcher's four proposed models of collaboration to deter-

mine their validity in school settings where collaboration between teachers and librarians occurs and the five constructs of collaboration within each model.

School Library Media Certification Program Review: Stakeholder Perspectives and Expectations

Donna Shannon, *University of South Carolina*

The ultimate aim of the project is to develop performance assessments that reflect AASL/NCATE standards and include stakeholder perceptions and expectations. Analysis and summaries of assessment data will be used for continuous program review.

1.2 ♦ Informal Discussion with Randall Bass

[Grand Ballroom C]

Moderator: Ken Haycock, *San Jose State University*

In an interactive setting, Randy Bass will take questions from participants and elaborate on his keynote address.

1.3 ♦ ALISE Awards Panel [Grand Ballroom E]

Moderator: Lynne McKechnie, *University of Western Ontario*

Eugene Garfield-ALISE Doctoral Dissertation Award
Understanding Implicit Feedback and Documents Preference: A Naturalistic User Study

Diane Kelly, *University of North Carolina at Chapel Hill*
(Dissertation completed at the School of Communication, Information and Library Studies, *Rutgers University*)

Dialog/ALISE Methodology Paper Award

Pictures Worth a Thousand Words: A Visual Approach to the Study of Libraries in the Home

Jenna Hartel, *University of California, Los Angeles*

ALISE Research Grant

From One-to-One to One-to-Many: A Study of the Relationship Between the Practicum and the Transition from Teacher to School Library Media Specialist

Marcia A. Mardis, *Wayne State University*

1.4 ♦ Supporting Education for Librarians in Developing Countries [Grand Ballroom F]

Organizer: Catherine Johnson, *University of Wisconsin-Milwaukee*

Library educators will share their experiences, challenges, and successes in providing educational support for library programs in developing countries.

Presenters:

- **Jamaica—Wendy Duff**, *University of Toronto*
- **Vietnamese Students—Pat Oyler**, *Simmons College*
- **Uganda/Developing E. African Consortium—Kendra Albright**, *University of Tennessee-Knoxville*
- **Distance Education Courses for African Students—Johannes Britz**, *University of Wisconsin-Milwaukee*
- **Mongolian Students and Programs—Catherine Johnson**, *University of Wisconsin-Milwaukee*

12:00 noon Birds of a Feather [La Joya Ballroom]

Organizer: Stephen Bajjaly, *University of South Carolina*

Meet with colleagues who share your teaching subject interests for informal, roundtable discussions about course content, teaching techniques, learning activities, and best practices. Attend looking for advice or offering knowledge and experiences. Discover contacts for the rest of the conference and beyond.

Moderators:

<i>Administration & Management:</i>	Tim Sineath , <i>University of Kentucky</i>
<i>Children's/YA Services:</i>	Lynne McKechnie , <i>University of Western Ontario</i>
<i>Collection Development:</i>	Bob Holley , <i>Wayne State University</i>
<i>Electronic Access:</i>	Eileen Abels , <i>University of Maryland</i>
<i>Health Sciences:</i>	Lynda Baker , <i>Wayne State University</i>
<i>Information Systems & Technologies</i>	Mike Eisenberg , <i>University of Washington</i>
<i>Public Libraries:</i>	Doug Raber , <i>University of Missouri – Columbia</i>
<i>Readers' Advisory Services:</i>	Loriene Roy , <i>University of Texas – Austin</i>
<i>Reference and Information Services</i>	Donna Shannon , <i>University of South Carolina</i>
<i>Research Methods</i>	Ann Curry , <i>University of British Columbia</i>

12:45 p.m.– 2:00 p.m. *Lunch on your own*

2:00 p.m. Session 2: Concurrent Panels & Juried Papers

2.1 ♦ Juried Papers 2: Teaching from a Distance: Is It Working? [Grand Ballroom B]

Moderator: Lydia Harris, *University of Washington*

Teaching a Process Online: How Do We Know They Learned What We Taught!

Lynn Akin, *Texas Woman's University*

Jeong Mee Lee, *Texas Woman's University*

Online courses that teach a process, such as cataloging or online searching, present issues that are hard to assess in distance education. This paper explores the relationship between embedded course goals and objectives, the nature of delivery, and the effectiveness of assessments when teaching processes online.

Does Residency Matter in Online Master's Degree Programs?

Michelle Kazmer, *Florida State University*

Many LIS programs have distance education components, and some offer their master's degrees entirely online. In the current study, the researcher explores students' community building, professional networking, and interpersonal support networks in a program without an on-campus component.

An Analysis of the Virtual Classroom: Does Size Matter? Do Residencies Make a Difference? Should You Hire that Instructional Designer?

Bruce Kingma, *Syracuse University*

Stacey Keefe, *Maxwell School of Citizenship, Syracuse University*

This study examines the impact of enrollment, faculty teaching experience, online faculty pedagogical training, and help from an instructional designer on student course evaluations.

2.2 ♦ Innovative Curriculum and Instruction in LIS Programs [Grand Ballroom C]

Curriculum SIG

Convener: Patricia Montiel Overall, *University of Arizona*

The attention LIS programs devote to constantly changing technological innovations is not matched by focus on the changing demographics of society. This panel discusses three areas needed in library and information science curricula to reflect diversity, proposes new courses for LIS curricula, and offers ways that current courses could develop diverse perspectives.

Presenters:

- **Latino Youth—Eliza Dresang**, *Florida State University*
- **Native American Populations—Lorlene Roy**, *University of Texas at Austin*
- **Language/Cultural Issues—Patricia Montiel Overall**, *University of Arizona*

2.3 ♦ Current Historical Scholarship: Papers in Honor of Donald G. Davis, Jr. [Grand Ballroom E]

Historical Perspectives SIG

Convener: Cheryl Knott Malone, *University of Arizona*

Three papers will be presented in honor of retiring LIS luminary Donald G. Davis, Jr.

Presenters:

- Quantifying the Goodness of Library History*, **Andrew Wertheimer**, *University of Hawaii*
- Collecting Contested Titles*, **Wayne A. Wiegand**, *Florida State University*
- Sylvia Beach and the American Library in Paris*, **Mary Niles Maack**, *University of California at Los Angeles*

2.4 ♦ Using Online Repositories in LIS Education

[Grand Ballroom F]

Organizer/moderator: Robert Allen, *Drexel University*

Online repositories are increasingly important for information management, and as such, are being incorporated into

LIS curriculum. This panel explores the educational opportunities and challenges in four areas related to the incorporation of online repositories in library education: principles of online repositories; technology issues; student engagement; and future directions.

Panelists:

J. Stephen Downie, *University of Illinois at Urbana-Champaign*

Patricia Galloway, *University of Texas*

Michael Lesk, *Rutgers University*

Xia Lin, *Drexel University*

2.5 ♦ Biomedical Informatics and LIS: Integration of the Interdisciplinary [Grand Ballroom A]

Organizer/panelist: Catherine Arnott Smith, *Syracuse University*

Panelists will discuss their educational backgrounds and interests; the content of medical informatics training; potential overlaps and useful synergies between LIS, medical informatics, and bioinformatics; and current challenges and opportunities for moving these domains closer together.

Panelists:

Catherine Arnott Smith, *Syracuse University*

James Andrews, *University of South Florida*

Steven MacCall, *University of Alabama*

Timothy Patrick, *University of Wisconsin - Milwaukee*

3:30 – 3:45 Afternoon Break

3:45 p.m. Session 2: Concurrent Panels & Juried Papers

3.1 ♦ Juried Papers 3: The Future Look of Our Professions [Grand Ballroom B]

Moderator: Bharat Mehra, *University of Tennessee*

Performance Appraisal as Social Construction of Identity

Gail Dickinson, *Old Dominion University*

This paper reports on the social construction of the role and job identity of the school library media specialist, based on a validation study of a new performance appraisal process.

Moving Toward Ethnic Diversity in LIS Education: Suggestions from Librarians of Color

Kyung-Sun Kim & Joanna Sin, *University of Wisconsin-Madison*

Using input from librarians of color who have experience with LIS programs, the presenters suggest effective strategies to improve the efforts of LIS schools in recruiting and retaining students of color.

Louder Please: Using Historical Research to Foster Professional Identity in LIS Students

Jean Preer, *Indiana University at Indianapolis*

The presenter uses primary documents from the American Library Association and the Carnegie Corporation, as well as an array of secondary materials, to explore the manner in which librarians have responded to social and technological changes.

3.2 ♦ Building Community in Distance Education Courses

[Grand Ballroom C]

New Faculty SIG

Convener: Eileen McElrath, *Texas Woman's University*

Feelings of isolation during the first two weeks of a course often jeopardize the student's continued enrollment in distance education programs. The panelists discuss relevant research and share activities they use to promote community building during that critical time.

Panelists:

Eileen McElrath, *Texas Woman's University*

Judy Marley, *University of South Carolina*

Kathleen McDowell, *University of Illinois at Urbana-Champaign*

3.3 ♦ Metadata Education Resources Clearinghouse:

Background and Future Plans [Grand Ballroom E]

Technical Services Methods SIG

Convener: Anita Coleman, *University of Arizona*

Moderators: C. Olivia Frost, *University of Michigan* and

Patricia Lawton, *University of Wisconsin-Madison*

Panelists highlight recommendations endorsed by ALCTS, ALISE and LC for metadata and cataloging education; raise awareness of the rich resources on the Metadata Education Resources Clearinghouse; and solicit input from educators and trainers on the development and management of the Clearinghouse.

Presenters:

▪ *Metadata Education: Three Levels of Competencies*—**Ingrid Hsieh-Yee**, *Catholic University of America*

▪ *The Metadata Education Resources Clearinghouse*—**Anita Coleman**, *University of Arizona*

▪ *The Growth, Use and Evaluation of the Clearinghouse*—**Shawne Miksa**, *University of North Texas* and **Sherry Velluci**, *Rutgers University*

3.4 ♦ Where All the Students Are Above Average? –

Combating Grade Inflation [Grand Ballroom F]

Organizer: Sydney Pierce, *Catholic University of America*

In a consumer-driven educational culture, faculty face increasing pressure from administrations and students when evaluating students. Experienced educators provide new faculty with a variety of ideas and approaches that will leave them better able to design and grade student work.

Presenters:

▪ *Making the Grade: Issues and Some Answers*—**Kathy Latrobe**, *University of Oklahoma*

▪ *An Exercise in Judgment – Applying Grading Standards*—**Sydney Pierce**, *Catholic University of America*

▪ *Does the Medium Change the Message? Online Environments*—**June Lester**, *University of Oklahoma*

▪ *Group Discussion: Grading Beliefs and Practices*—**Martha M. Hale**, *Catholic University of America*

5:30 p.m.– 7:00 p.m. Past Presidents' Reception

(by invitation only) [Presidential Suite]

Sponsored by San Jose State University

5:45 p.m.– 6:15 p.m. Setup: Doctoral Poster Session

[Grand Ballroom]

5:45 p.m.– 6:15 p.m. Meeting of Doctoral Poster Session

Judges [Pre-function Area]

6:15 p.m.– 8:15 p.m. Doctoral Poster Judging

[Grand Ballroom]

8:30 p.m.– 10:00 p.m. Doctoral Student Research Poster Session and Reception

[Grand Ballroom]

IN MEMORIAM

Ethel Auster

Marcy I. Murphy

Laurel Ann Clyde

LaVahn Overmyer

Sheila Egoff

Patricia Jensen

Margaret Hodges

Paul Ricoeur

Haynes McMullen

Kenneth Decker Shearer

Margaret Monroe

Gerald Shields

Wednesday, January 18, 2006

7:30 a.m.–8:30 a.m.	<i>School Representatives' Breakfast</i>	La Joya Ballroom
8:00 a.m.–7:00 p.m.	<i>Registration</i>	Pre-function Area
8:00 a.m.–8:00 p.m.	<i>Placement Services</i>	Pre-function Area
8:00 a.m.–5:00 p.m.	<i>Exhibits</i>	Pre-function Area
8:00 a.m. –8:45 a.m.	<i>SIG Session 1</i>	Grand Ballroom (sections A–F)
9:00 a.m. –10:30 a.m.	<i>Session 4: Concurrent Panels & Juried Papers</i>	Grand Ballroom (sections B, C, E, F)
11:00 a.m.–12:30 p.m.	<i>Session 5: Concurrent Panels & Juried Papers</i>	Grand Ballroom (sections B, C, E, F)
12:45 p.m.–1:30 p.m.	<i>SIG Session 2</i>	Grand Ballroom (sections A–F)
1:45 p.m.–3:15 p.m.	<i>Session 6: Concurrent Panels & Juried Papers</i>	Grand Ballroom (sections B, C, E, F)
3:45 p.m.–5:30 p.m.	<i>ALISE Business Meeting</i>	Grand Ballroom
6:30 p.m.–8:00 p.m.	<i>¡OLE! Awards Reception (Margaritas and cash bar)</i>	Grand Ballroom

7:30 a.m. School Representatives' Breakfast [La Joya Ballroom]

8:00 a.m. SIG Session 1. Business, Planning, and Discussion Meetings

Conveners:

- *Continuing Education*—**Belinda Boon**, *University of Texas* [Grand Ballroom A]
- *Distance Education*—**Dan Barron**, *University of South Carolina* and **Lydia Harris**, *University of Washington* [Grand Ballroom B]
- *Gender Issues*—**Suzanne M. Stauffer** [Grand Ballroom C]
- *Information Ethics*—**Toni Samek**, *University of Alberta* [Grand Ballroom D]
- *Preservation Education*—**Karen Gracy**, *University of Pittsburgh* [Grand Ballroom E]
- *Research*—**Toni Samek**, *University of Alberta* and **Christine Pawley**, *University of Iowa* [Grand Ballroom F]

9:00 a.m. Session 4: Concurrent Panels & Juried Papers

4.1 ♦ Juried Papers 4: The Relationship between Research and Education [Grand Ballroom B]

Moderator: **Connie Van Fleet**, *University of Oklahoma*

Seeking Synchronicity: Evaluating Virtual Reference Transcripts

Marie Radford, *Rutgers, the State University of New Jersey*
Lynn Silipigni Connaway, *OCLC Online Computer Library Center, Inc.*

The present study extends the research literature on chat services by conducting the first evaluation of transcripts randomly selected from an international VRS provider.

Values Embedded in IT: Applying a Research Agenda to Education and Practice

Ken Fleischmann, *Florida State University*

This paper focuses on the applications of an NSF-funded research agenda on embedded values for both education and practice in information technologies

The Role of Theory in Research as One of the Components of LIS Education

Fran Miksa, *University of Texas at Austin*

Two approaches to theory—theories related to phenomena, and meta-theories as ontological positions—are made the basis of how research that is theory-based might be a component of LIS education.

4.2 ♦ Information Ethics Positioning in LIS Teaching & Scholarship: An Interactive Session [Grand Ballroom C] *Information Ethics SIG*

Convener: **Toni Samek**, *University of Alberta*

This interactive session provides a forum for discussion about development of a position statement on information ethics in LIS education.

Moderators:

Toni Samek, *University of Alberta*

Thomas Froehlich, *Kent State University*

4.3 ♦ Effective Strategies for Integrated Teaching and Assessment in LIS Education [Grand Ballroom E]

Deborah S. Grealy & Sylvia Hall-Ellis, *University of Denver*

This program outlines presenters' adaptation of the Davis model and illustrates how key LIS learning objectives are met and measured in classes. The initial presentation will be followed by open round-table discussion of alternative strategies.

4.4 ♦ Beyond the Textbook: Innovative Approaches to Connecting Theory and Practice for LIS Education [Grand Ballroom F]

Organizer: **Kate Marek**, *Dominican University*

The presenters will describe a research-based approach to pedagogy and present specific successful techniques that

connect theory to practice and promote student-centered learning.

Presenters:

- *Use of Fiction*—**Kate Marek**, *Dominican University*
- *Use of Sequenced Questions*—**Karen B. Brown**, *Dominican University*
- *Use of Nonfiction*—**Martha Hale**, *Catholic University of America*

10:30 a.m. – 11:00 a.m. Morning break

11:00 a.m. Session 5: Concurrent Panels & Juried Papers

5.1 ♦ Juried Papers 5: Preparing Future Professionals: Competencies and Skills [Grand Ballroom B]

Moderator: **Kimberly Black-Parker**, *University of Kentucky*

What Does a Newcomer Librarian Need to Know? A Study of Organizational Socialization in Academic and Research Libraries

Ming-Hsin Chiu, *University of Wisconsin-Madison*

This study investigates the contents and sources of socialization information acquisition newcomer librarians seek during the socialization process.

Electronic Records Education in Archives and Records Management—Skills, Knowledge Taught in Current MLS Programs

Judit Olah, *University of North Carolina - Chapel Hill*

The presenter describes key components in ARM education tracks and suggests that a new perspective of traditional tracks can attract a student population interested in learning about various bibliographic techniques and methods of document organization.

Use of Professional Competencies and Standards Documents for Curriculum Planning, Continuing Education, and Assessment of Public Libraries

June Lester & Connie Van Fleet, *University of Oklahoma*

The presenters discuss use of competency documents in schools of library and information studies, state library agencies, and public libraries.

5.2 ♦ Juried Papers 6: Serving Our Students with Creative Teaching, Session I [Grand Ballroom C]

Moderator: **Dan Barron**, *University of South Carolina*

Instant Messaging in Class Settings: Stories about Student-Instructor Interactions

Wooseob Jeong, *University of Wisconsin-Milwaukee*

This study analyzes opinions of students who participated in IM communication in class settings and identifies potentials, obstacles, and optimal conditions for IM usage for classes.

Online Asynchronous Threaded Discussions: Good Enough to Advance Students through the Proximal Zone of Activity Theory?

Paula San Millan Maurino, *Long Island University*

A discussion of student-to-student interaction focuses on student satisfaction with online classroom discussions and the environment's effectiveness in promoting the social/cultural learning emphasized in Activity Theory and the Social Computing paradigm.

Active Learning in a Virtual Classroom: A Case Study

Lilia Pavlovsky, *Rutgers University*

This study explores an asynchronous learning environment and the nature of active learning and social interaction within distance education programs.

5.3 ♦ Information Literacy Assessment: Examining Issues from a System and Global Approach

[Grand Ballroom E]

Lesley Farmer, *California State University-Long Beach, College of Education/Dept. of EdPAC*

This session provides a meta-analysis of the patterns and trends in the assessment of content related to information literacy and the approaches used to measure knowledge, skills, and dispositions.

5.4 ♦ Research in Youth Services Librarianship: Where Are We Now and Where Do We Go From Here?

[Grand Ballroom F]

Youth Services SIG

Conveners: **Melanie Kimball**, *University at Buffalo, State University of New York*

Christine Jenkins, *University of Illinois at Urbana-Champaign*

The presenters discuss recent research on all aspects of youth services and provide a forum for LIS educators to identify and discuss a research agenda to inform youth services librarianship.

Presenters:

- *Youth Services in Public Libraries*—**Melissa Gross**, *Florida State University*
- *Youth Services in School Libraries*—**Nancy Everhart**, *Florida State University*

12:30 p.m.– 1:45 p.m. Lunch on your own

12:45 p.m. SIG Session 2. Business, Planning, and Discussion Meetings

▪ *Doctoral Students*—**Lynne Barrett**, *Florida State University* & **Baris Aksakal**, *University of North Texas* [Grand Ballroom A]

▪ *New Faculty*—**Rebecca McElrath**, *Texas Woman's University* [Grand Ballroom B]

▪ *Part Time/Adjunct Faculty*—**Daniel Callison**, *Indiana University at Indianapolis* & **Mikel Breitenstein** [Grand Ballroom C]

▪ *Information Policy*—**Kendra Albright**, *University of Tennessee at Knoxville* & **Sam Trosow**, *University of Western Ontario* [Grand Ballroom D]

▪ *International Library Education*—**Susan Freiband**,
University of Puerto Rico [Grand Ballroom E]

▪ *Youth Services*—**Melanie Kimball**, University at Buffalo,
SUNY & **Christine Jenkins**, University of Illinois at Ur-
bana-Champaign [Grand Ballroom F]

1:45 p.m. Session 6: Concurrent Panels & Juried Papers

6.1 ♦ Juried Papers 7: Preparing Students for Academic and Research Libraries [Grand Ballroom B]

Moderator: Julie Hersberger, University of North Carolina
-Greensboro

*What Practitioners Have to Say about Preparing Subject
Specialists for Academic and Research Libraries*

Diane L. Barlow & Patricia Fisher, University of Maryland

This presentation addresses questions related to the poten-
tial shortage of subject specialists for academic and re-
search libraries, particularly focusing on curriculum design
for preparing students with advanced degrees to become
subject specialists.

*What Do We Know about the Subject Specialists? Qualities
and Characteristics of the Advanced Degree Holders Who
Are Likely to Become Subject Specialists in Academic and
Research Libraries*

Ming-Hsin Chiu, Louise S. Robbins, & Fang-Shu Ou
(Department of Statistics) University of Wisconsin-Madison

This study identifies the qualities and characteristics of
advanced degree holders pursuing master's degrees in LIS,
their projected career paths, and the factors that attracted
them to choose librarianship.

Supporting Librarian Research: Penn State's Experience

Joseph Fennewald, Penn State-Hazleton

Penn State often appears among the top ten institutions in
library research productivity and administrators often credit
institutional requirements and support for this accomplish-
ment. This study explores the subjective experience of a
diverse sample of PSU librarian researchers.

6.2 ♦ Information Seeking and Service Delivery for Communities in Disaster/Crisis [Grand Ballroom C]

Multicultural, Ethnic & Humanistic Concerns (MEH) SIG

Conveners: Nahyun Kwon, University of South Florida &
Chris Hagar, University of Illinois at Urbana-Champaign

Four papers explore conceptual frameworks of information
seeking behavior, humanistic approaches, service models,
and education in the context of communities in crisis.

*What Influences International Students' Disaster-Related
Information Seeking Online If a Disaster Hits Their Country?*

Hung-Yi Lu, College of Public Health, University of Ken-
tucky, coauthored with **Mia Liza A. Lustria, Donald O.
Case, James Andrews, Nahyun Kwon, Sarah Cavendish,**
and **Bernikki R. Floyd**

*Designing a Major Municipal Police Department's Com-
mand and Control Structure: How Distributed Cognition Can
Enhance Interagency Coordination in Crises Management*
John J. Sullivan, Long Island University

*Using Research to Aid the Design of a Crisis Information
Management Course*

Chris Hagar, University of Illinois at Urbana-Champaign

*Information as a Critical Resource during Emergencies or
Disasters from a World Perspective: A Classroom Learning
Experience*

Maria T. Chavez-Hernandez & Arif Dagli, Florida State
University

6.3 ♦ Interdisciplinary Research and Practice: Informat- ics as a Case Example [Grand Ballroom E]

Moderator: Nancy K. Roderer, Welch Medical Library,
Johns Hopkins University

Panelists offer multiple perspectives drawn from informat-
ics training programs in which there is an LIS component.

Panelists:

Soraya Assar, Clinical Knowledge Group, Eclipsys
Corporation

Sherrilynne Fuller, Medical Education and Biomedical
Informatics, University of Washington

Charles Friedman, National Library of Medicine, Divi-
sion of Extramural Programs

Prudence W. Dalrymple, Johns Hopkins University

6.4 ♦ Two IMLS Grants for Librarians of the 21st Century Program: A PhD and an Archives Program Bring New Vision to Educate LIS Students for Leadership and Diversity in Our Global Culture [Grand Ballroom F]

Organizer: Tula Giannini, Pratt Institute

Two IMLS grants demonstrate fresh approaches to educat-
ing students in key areas of need in LIS education.

Presenters:

▪ *GATEWAY program*—**Tula Giannini**, Pratt Institute

▪ *Doctoral Program in Managerial Leadership for the Infor-
mation Professions*—**Michele Cloonan**, Simmons College

3:15 p.m.— 3:45 p.m. *Afternoon Break with Bowker*
[La Joya Ballroom]

Bowker's Library School Initiative program offers compli-
mentary access to *BooksInPrint.com* and *GlobalBooksIn-
Print.com* for instructional use. Remote or on-site training
as well as written instruction guides to aid in the integration
of Bowker's database products with your collection, acqui-
sition, and reference courses.

3:45 p.m.— 5:30 p.m. **ALISE Business Meeting**
[Grand Ballroom]

6:30 p.m.— 8:00 p.m. **¡OLE! All Conference & Awards
Fiesta** (1 hour free margarita reception and cash bar)
[Grand Ballroom]

Thursday, January 19, 2006

7:30 a.m.–12:00 noon	<i>Registration</i>	Pre-function Area
8:00 a.m.–12:00 noon	<i>Placement Services</i>	Pre-function Area
8:00 a.m.–12:00 noon	<i>Exhibits</i>	Pre-function Area
8:00 a.m.–9:00 a.m.	<i>Accreditation Reporting with ALA Staff</i>	Colonnade Ballroom
8:00 a.m.–8:45 p.m.	<i>SIG Session 3</i>	Grand Ballroom A–F
9:00 a.m.–10:00 a.m.	<i>Developing the Program Presentation</i>	Colonnade Ballroom
9:00 a.m.–10:30 a.m.	<i>Session 7: Concurrent Panels & Juried Papers</i>	Grand Ballroom B,C, E, F
10:30 a.m.–2:30 p.m.	<i>Canadian Council of Information Studies (CCIS-CCSI)</i>	Bolo's Dining Room
10:45 a.m.–12:15 p.m.	<i>Session 8: Concurrent Panels & Juried Papers</i>	Grand Ballroom B,C, E, F
12:45 p.m.–1:30 p.m.	<i>Closing Session</i>	Grand Ballroom
1:45 p.m.–2:30 p.m.	<i>Assistant/Associate Deans SIG</i>	Board Room
2:30 p.m.–3:30 p.m.	<i>JELIS Editorial Board Meeting</i>	Sam Houston
2:30 p.m.–3:30 p.m.	<i>ALISE Board Meeting with Committee Chairs & SIG Conveners</i>	Colonnade Ballroom C
3:30 p.m.–6:30 p.m.	<i>ALISE Board of Directors Meeting 3</i>	Colonnade Ballroom B

8:00 a.m. Accreditation Reporting with ALA Staff

[Colonnade Ballroom]

Karen O'Brien, Renée McKinney, & Steven Giese, ALA Office for Accreditation

8:00 a.m. SIG Session 3. Business, Planning, and Discussion Meetings

- *Archival/Records Management Education*—**Lynne Chase, Emporia State University** [Grand Ballroom A]
- *Curriculum*—**Patricia Montiel Overall, University of Arizona** [Grand Ballroom B]
- *Historical Perspectives*—**Cheryl Knott Malone, University of Arizona** [Grand Ballroom C]
- *Multicultural, Ethnic and Humanistic Concerns*—**Chris Hagar, University of Illinois & Nahyun Kwon, University of South Florida** [Grand Ballroom D]
- *Teaching Methods*—**Jim Elmborg, University of Iowa** [Grand Ballroom E]
- *Technical Services Education*—**Anita S. Coleman, University of Arizona & Edward Lomax, Georgia State University** [Grand Ballroom F]

9:00 a.m. Developing the Program Presentation

[Colonnade Ballroom]

Presenter: Thomas Leonhardt, COA Chair & Karen O'Brien, ALA Office for Accreditation Director

This program is designed for schools who have a site visit scheduled during or between fall 2006 and spring 2008; for those developing a pre-candidacy application; and for those who have achieved pre-candidacy status.

Panelists:

Danny Callison, Indiana University (External Review Panel Chair)
Mary Westermann-Cicio, Long Island University

Phil Mulvaney, Northern State University (External Review Panel Chair)

Rick Rubin, Kent State University (COA)

9:00 a.m. Session 7: Concurrent Panels & Juried Papers

7.1 ♦ Juried Papers 8: Serving Our Students with Creative Teaching, Session II [Grand Ballroom B]

Moderator: Doug Raber, University of Missouri - Columbia

Inquiry-Based Learning in LIS Education - A Direct Connect to Scholarship of Teaching and Learning: A Case Study
Muzhgan Nazarova, Bertram Bruce, & Ann Bishop, University of Illinois at Urbana-Champaign

Building on similarities between John Dewey's (1938) cycle of inquiry and Ernest Boyer's (1990) four types of scholarship, the authors describe the importance of making inquiry-based learning a key component in LIS education.

Issues and Challenges of Integrating Service Learning in a Library Automation Course

Mary Alice Ball & Katherine Schilling, Indiana University at Indianapolis

This paper describes the rewards, issues, and challenges related to implementing a redesigned library automation course that reflects the School's service learning philosophies.

Teaching and Learning across Delivery Formats

Don Wicks & Richard E. Rubin, Kent State University

This study compares the impact of three modes of instruction - videoconferencing, face-to-face, and web delivery - on perceptions of learning in a graduate level LIS course.

7.2 ♦ Inquiry with an Edge: Critical Research in Library and Information Science [Grand Ballroom C]

Research Methods SIG

Conveners: **Christine Pawley**, *University of Iowa* & **Toni Samek**, *University of Alberta*

Presenters explore research techniques that incorporate a critical or emancipatory approach and discuss ways in which the research endeavor can be linked to social and political action.

Presenters:

- *Approaches to Critical Research*—**Christine Pawley**, *University of Iowa*
- *Intellectual Freedom*—**Toni Samek**, *University of Alberta*
- *Intellectual Property*—**Kenneth Himma**, *Department of Philosophy, Seattle Pacific University*
- *Organization of Information*—**Hope A. Olson**, *University of Wisconsin at Milwaukee*
- *Publishing Critical Research*—**Ajit Pyati**, *University of California, Los Angeles*

7.3 ♦ Student Outcome Assessment: COA and Regional Accreditation Practices [Grand Ballroom E]

Rachel Applegate, *Indiana University at Indianapolis*

The shift in focus of regional accrediting agencies towards assessing student outcomes, particularly student learning, has helped instigate a “culture of assessment” at the level of the institution. This presentation and discussion will review methods SLIS schools have included in Program Presentations for assessing and documenting program-level student learning outcomes, and will discuss a range of potential methods.

7.4 ♦ The Effect of NCATE Requirements on Program Assessments in School Library Media [Grand Ballroom F]

Organizer: **Gail Dickinson**, *Old Dominion University*

Presenters from three NCATE-accredited school library media programs will provide case studies in implementing the new NCATE assessment, with each emphasizing challenges presented at different stages of the process.

Panelists:

Gail Dickinson, *Old Dominion University*
Audrey Church, *Longwood University*
Judith Repman, *Georgia Southern University*

10:30 a.m.– 10:45 a.m. *Morning Break*

10:30 a.m. **Canadian Council of Information Studies**
[Bolo's Dining Room]

10:45 a.m. **Session 8: Concurrent Panels & Juried Papers**

8.1 ♦ Juried Papers 9: Olío

[Grand Ballroom B]

Moderator: **Danny P. Wallace**, *University of Oklahoma*

Cyber Security Education in LIS Programs

Lewis Hassell, Jennifer Burke, & Sarah Hughes-Hassell,
Drexel University

The presenters examine the attention paid to the concept of information security in LIS programs with research that recognizes the integral relationship between security and privacy.

Tenure – the Moving Target

Susan Higgins, *University of Southern Mississippi*

Through documentation of institutional requirements for tenure and the personal experience of the respondents, this study describes the manner in which LIS program directors learned to balance personal professional autonomy and organizational responsibilities and the impact of tenure on their teaching and research.

Global Access to Cross-cultural and Cross-lingual Resources: Current Research Trends and Implications for LIS Curricula

Jung-ran Park, *Drexel University*

This paper focuses on information organization studies dealing with cross-cultural and cross-lingual resource discovery, investigates the current status of international bibliographic control and standardization for data exchange and sharing, and presents the implications for LIS curricula.

8.2 ♦ OCLC/ALISE 2005 Library and Information Science Research Grant Program Award Papers

[Grand Ballroom C]

Moderator: **Lynn Silipigni Connaway**, *Online Computer Library Center, Inc.*

The 2005 grant recipients will report on the progress and results of their research. There will be time for discussion of the research and to address specific questions about the OCLC/ALISE Research Grant Program.

A Survey of the Extent and Utilization of Cataloging Tools and Resources within Technical Services in the North Texas Public Libraries

Shawne Miksa, *University of North Texas*

The Mining of Cataloging Knowledge from Bibliographic Data for Automatic Subject Cataloging

Jun Wang, *Peking University* & **Hong Xu**, *University of Pittsburgh*

A Dual Approach to Web Query Mining: Towards Conceptual Representations of Information Needs

Peiling Wang, *University of Tennessee at Knoxville*

8.3 ♦ Critical Consciousness and LIS Education

[Grand Ballroom E]

Teaching Methods SIG

Convener: **James Elmborg**, *University of Iowa*

Using Paulo Freire's concept of “problem posing education,” this program will explore ways that educators can help students de-center their own expectations, become

more aware of the social and political dimensions of information and develop critical consciousness.

Presenters:

▪ *Language, Literacy, and Librarianship*—**James Elmborg**, University of Iowa

Feminist Pedagogy and Academic Librarianship—**Patti Ryan**, York University

Unfinished Business: LIS and the Integration of Library Schools—**Maurice B. Wheeler**, University of North Texas

Education for a Global Perspective—**Sergio Chaparro-Univazo**, Simmons College

8.4 ♦ Issues in Scholarly Communication: Electronic Publishing, Open Access and JELIS [Grand Ballroom F]

Organizers: Cheryl Malone (moderator), University of Arizona & Anita Coleman, University of Arizona

Presenters:

▪ *Not-for-profit Scholarly Societies and Open Access Journal Publishing*—**Carol Tenopir**, University of Tennessee at Knoxville

▪ *The Publishing Cooperatives and the Transition to Open Access*—**Raym Crow**, SPARC

▪ *Findings from a Citation Study of JELIS, 1984-2004*—**Anita Coleman**, University of Arizona

12:15 p.m.– 12:45 p.m. Break

12:45 p.m. Closing session: Conference Re-cap [Grand Ballroom]

Happy Trails: a Montage—**Julie Hersberger**, University of North Carolina-Greensboro

Remarks **ALISE President John Budd**, University of Missouri-Columbia

1:30 p.m.– 2:30 p.m. Lunch on your own

1:45 p.m. Assistant/Associate Deans SIG Business Meeting
Convener: Denise Davis, Simmons College [Board Room]

2:30 p.m. JELIS Editorial Board Meeting [Sam Houston]

2:30 p.m. ALISE Board of Directors Meeting With Committee Chairs and SIG Conveners [Colonnade Ballroom C]

3:30 p.m. ALISE Board of Directors Meeting 3 [Colonnade Ballroom B]

ALISE 2006 AWARD WINNERS

Teaching and Service Awards

Teaching Excellence in the Field of Library and Information Science Education

Jean L. Preer, Indiana University at Indianapolis

Service to the Association for Library and Information Science Education

Elizabeth S. Aversa, University of Alabama

Pratt-Severn Faculty Innovation Award

Bertram Bruce, University of Illinois at Urbana-Champaign

2005 Doctoral Students to ALISE
(sponsored by Libraries Unlimited)

Karen Cook, University of Alabama

Abe Crystal, University of North Carolina

Research Awards

Eugene Garfield—ALISE Doctoral Dissertation Award

Diane Kelly, Rutgers University

Honorable mention:

Anabel Quan Haase, University of Toronto
Weiping Yu, University of New South Wales

Dialog/ALISE Methodology Paper

Jenna Hartel, University of California

ALISE Research Grant

Marcia A. Mardis, Wayne State University

OCLC—ALISE Library and Information Science Research Grant

Joyce Kanini Mbvesa, University of Nairobi

Lokman Meho & Kiduk Yang, Indiana University

Jeffrey Pomerantz, University of North Carolina at Chapel Hill

Louise Spiteri, Dalhousie University

ALISE 2005 Board of Directors

President

Ken Haycock, *San Jose State University*

Vice President

John Budd, *University of Missouri-Columbia*

Past-President

Louise Robbins, *University of Wisconsin-Madison*

Director of Finance

James Benson, *St. John's University*

Director for Special Interest Groups

Linda C. Smith, *University of Illinois at Urbana-Champaign*

Director for Membership Services

Gloria Leckie, *University of Western Ontario*

Director for External Relations

Heidi Julien, *University of Alberta*

ALISE Staff

Deborah York, Executive Director

Fred Rascoe, Assistant Director

Jeremy Unthank, Information Coordinator

Resolutions

Written copies of all resolutions, including resolutions contained in committee reports, must be given to the membership before they are to be presented to that body for action. To permit this, text must be submitted to the Governance Committee 24 hours in advance of presentation. A resolution that has fiscal implications must be submitted to the President as well as the Governance Committee 24 hours before it is to be voted on so that the Budget Committee can provide information on fiscal implications.

Resolution approved January 13, 1979, limits resolutions to statements on substantive matters relating to library education and the profession of librarianship to be voted on by membership.

2006 Conference Program Planning Committee

Co-Chairs:

Julie Hersberger, *University of North Carolina-Greensboro*

Connie Van Fleet, *University of Oklahoma*

Committee Members:

Suzie Allard, *University of Tennessee*

John Budd, *University of Missouri-Columbia*

Michele Cloonan, *Simmons College*

Ken Haycock, *San Jose State University*

Lynne McKechnie, *University of Western Ontario*

Alvin Schrader, *University of Alberta*

Linda C. Smith, *University of Illinois at Urbana-Champaign*

Governance Committee

Louise Robbins, *University of Wisconsin-Madison*
(chair)

Elizabeth Aversa, *University of Alabama*

Toni Carbo, *University of Pittsburgh*

Prudence Dalrymple, *Dominican University*

Vision

By 2008, ALISE will be the visionary organization in Library and Information Science education. The Association will be known for its unique purpose, build its strength and communicate that strength through vision, voice and visibility.

Mission

ALISE promotes excellence in research, teaching and service for Library and Information Science educators through leadership, collaboration, advocacy and dissemination of research.

Enduring Purpose

ALISE promotes research that informs the scholarship of teaching and learning for Library and Information Science, enabling members to integrate research into teaching and learning.

Strategic Directions (2004-2006)

1. **Achieve the Association's Unique Purpose** through focus on the scholarship of teaching and learning and the enhancement of research;
2. **Promote the Association's Unique Purpose** through marketing and communication of the ALISE vision;
3. **Ensure Membership Growth** to Develop the Association's Unique Purpose through strategic development of new special interest groups and targeted growth;
4. **Enhance Revenue Streams** to Extend the Association's Unique Purpose. through planned development and advancement and new initiatives;
5. **Restructure to Achieve** the Association's Unique Purpose, through a realignment of Board responsibilities, restructuring and accountability of committees and translation of this strategic plan into specific, measurable, active, relevant and timed objectives.

ALISE Silent Auction Listing

- | | |
|---|---|
| 1. "Curl up with a Good Book" basket / \$175.00 | 14. Libraries Unlimited book package/ \$500.00 |
| 2. A Memorial Day Weekend at Whistler / \$1,000.00 | 15. Medical Library Association Encyclopedic Guide set (3 volumes plus CD-ROM) / \$495.00 |
| 3. Artistic plate by Steven Mahler/ \$100.00 | 16. One-year Ebook subscription / \$2000.00 |
| 4. Canadian Coffee Break / \$10.00 | 17. One-year institutional print subscription to <i>Library Trends</i> / \$110.00 |
| 5. Carnelian necklace and earrings / \$40.00 | 18. One-year institutional print subscription to <i>The Bulletin of the Center for Children's Books</i> / \$75.00 |
| 6. <i>Cicero</i> , edited by Paulus Manutius, printed by the Aldine press, 1559 / \$300 | 19. Pawleys Island rope hammock / \$80.00 |
| 7. Editorial services / \$400.00 | 20. Six "See Men Read" calendars / \$20.00 each |
| 8. Ex Libris afghan / \$59.00 per DEMCO catalog | 21. <i>Sound of Strings</i> by Harold Keith / \$35.00 (per Alibris) |
| 9. Five Ex Libris ties / \$39.00 each | 22. <i>Texasville</i> by Larry McMurtry / \$42.00 (per Alibris) |
| 10. Five Valentine gift baskets / \$75.00 each | 23. Tom Robbins' <i>Villa Incognito</i> / \$42.00-\$80.00 (per Alibris) |
| 11. Framed photograph / \$200.00 | 24. Unakite and silver rosary / \$60.00 |
| 12. Indonesian carving of woman / \$35.00 | |
| 13. Librarian's Choice 2004 (10 Copies) / \$15.00 | |

Thanks to Our Conference Sponsors

President's Circle (\$10,001+)



Partner (\$5,001–10,000)

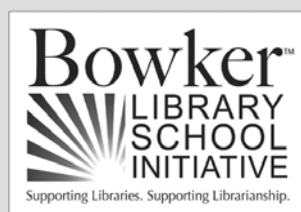

Associate (\$1,501–5,000)



Friend (\$100–750)



San José State
UNIVERSITY

Doctoral Student Reception Sponsoring Schools:

Catholic University
Drexel University
Emporia State University
Florida State University
Indiana University
Long Island University
Louisiana State University
Rutgers University
Simmons College
Syracuse University
Texas Woman's University
University at Albany
University of Alabama
University of British Columbia
University of Hawaii
University of Illinois at Urbana-Champaign
University of Kentucky
University of Maryland
University of Michigan
University of Missouri-Columbia
University of North Carolina at Chapel Hill
University of North Texas
University of Oklahoma
University of Pittsburgh
University of South Carolina
University of Tennessee
University of Texas
University of Washington
University of Wisconsin-Madison
Wayne State University

Floor Map: Omni San Antonio

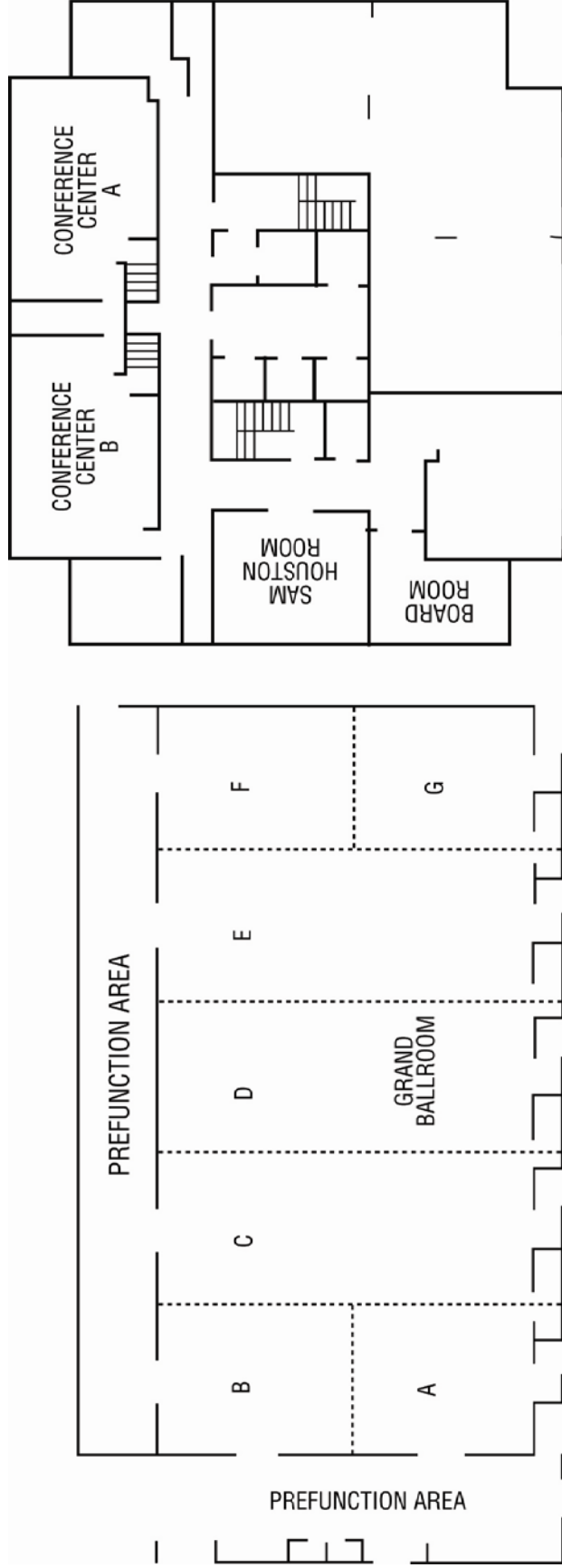

FIRST FLOOR

SECOND FLOOR

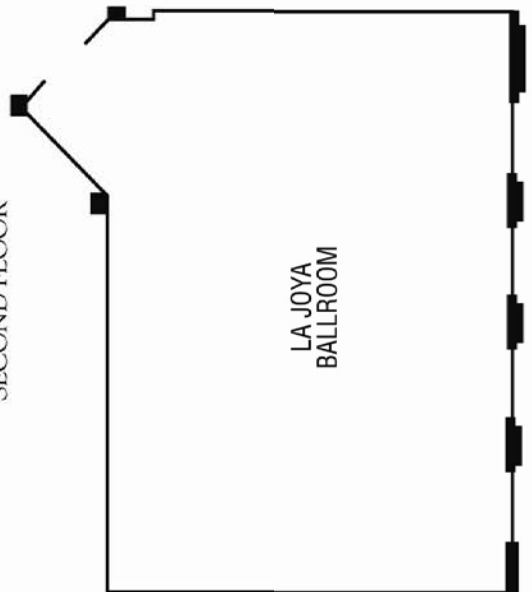

FIRST FLOOR

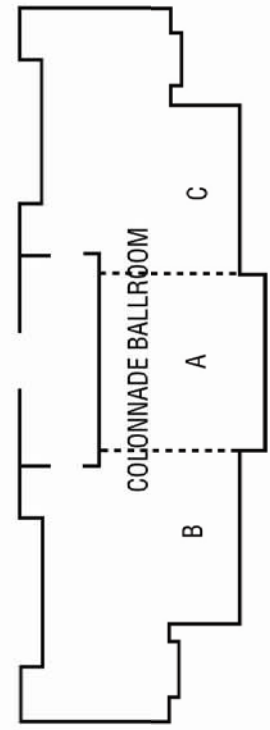

TWENTIETH FLOOR

Seattle in 2007!

Habits of Mind and Practice: Preparing Reflective Professionals

January 15–18, 2007
Grand Hyatt Seattle



Association for Library and Information Science Education
1055 Commerce Park Drive, Tech Center 1
P.O. Box 4219
Oak Ridge, Tennessee 37831-4219
www.alise.org contact@alise.org